

INSTALLATION & MAINTENANCE GUIDE

AMP® SECURE Area Light

ITEM: ASA-4301-90S-UNV-S-AM

SAVE THESE INSTRUCTIONS

! IMPORTANT SAFETY INSTRUCTIONS

READ CAREFULLY BEFORE INSTALLING FIXTURE. RETAIN THESE INSTRUCTIONS FOR FUTURE REFERENCE.

Fixtures must be wired in accordance with all local codes and the National Electrical Code.

Proper grounding is required for safety.

THIS PRODUCT MUST BE INSTALLED IN ACCORDANCE WITH THE APPLICABLE INSTALLATION CODE BY A PERSON FAMILIAR WITH THE CONSTRUCTION AND OPERATION OF THE PRODUCT AND THE HAZARDS INVOLVED.

WARNING: Make certain power is OFF before installing or maintaining fixture. No user-serviceable parts inside. Suitable for Wet locations.

! IMPORTANT: PLEASE READ BEFORE INSTALLATION

1. This LED area light uses the latest in solid state lighting technology for long life, low maintenance, and high efficiency.
2. An internal power-factor-corrected switch-mode supply allows it to be used from any nominal 120V~277V driver without any variation in light output.
3. Suitable for use in the following locations:
 - Ambient Temp: -40~+40°C (-40~+104°F)
 - Wet Locations
4. Be sure the supply voltage is suitable for the Luminaire voltage.

PACKAGE CONTENTS

- (1) Luminaire
- (1) Photocell
- (1) Gasket
- (1) Flat Gasket
- (1) Backplate
- (2) Mounting Screw
- (5) P4 Wire Connectors

PRODUCT DIMENSIONS

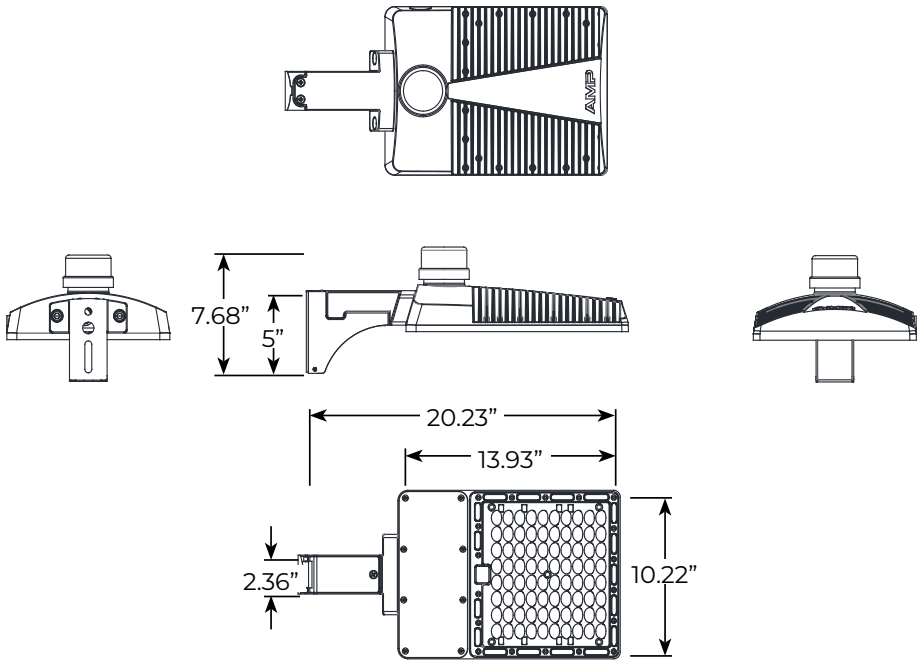

1 REMOVE SCREW ON THE BOTTOM OF THE ARM

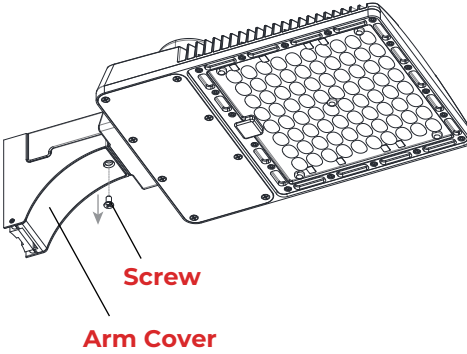

Access the wiring compartment by removing the screw from the arm cover.

2 REMOVE THE ARM

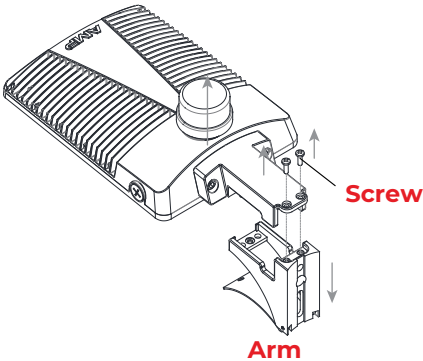

Remove the top (2) screws as shown to remove the arm from the luminaire.

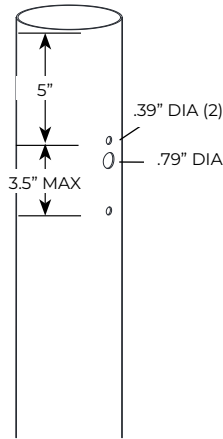

Mount the area light to square or round pole.
 The backing plate is adjustable and is adjustable to the dimensions on the above drawing.
 Use the dimensions on the drawing to drill the required hole pattern if the pole is not drilled.

4 ADJUST BLOCK LOCATIONS ON THE BACKING PLATE

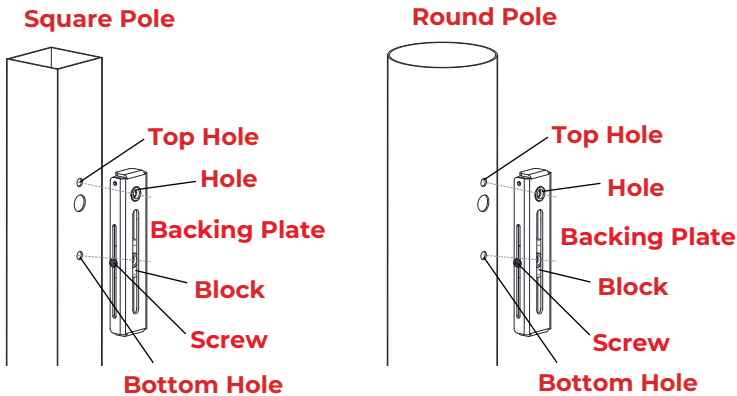

Insert and hold the backing plate into the pole.
 Place the gasket for the round or square pole between the pole and the arm.
 Securely tighten with (2) Screws.

5 PHOTOCELL INSTALLATION



Loosen the (2) screws on the receptacle and rotate the photocell receptacle so the arrow points north.

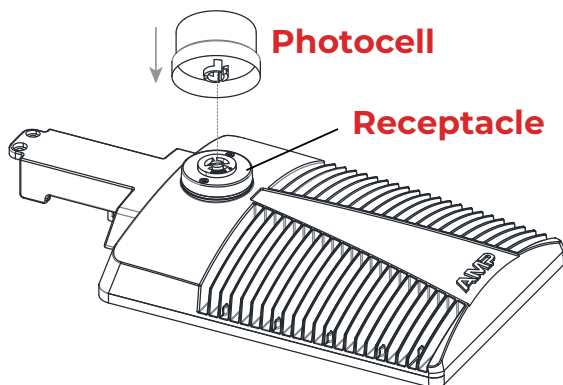

Insert the twist lock photocell into the receptacle and rotate until it stops.

The photocell goes in one way, the large tab into the large slot.

6 INSTALL LUMINAIRE

Route the luminaire wires through the hole on the arm. Attach the fixed arm of the luminaire onto the arm and secure with previously removed screws. Hand tighten until snug.

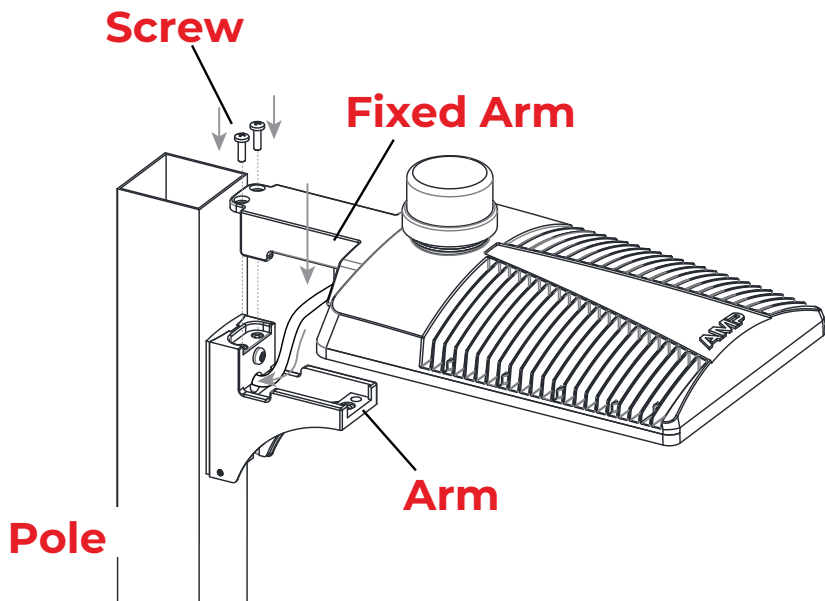

7 CONNECT LUMINAIRE WIRES TO SUPPLY WIRES

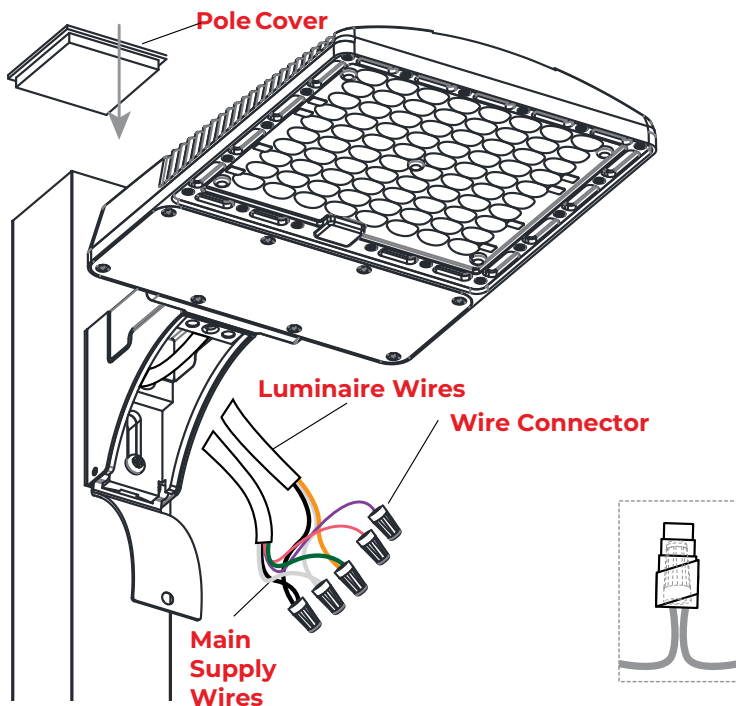

Feed the supply wires and luminaire wires into the arm wiring compartment. Make the connections as follows:

Connect the green ground wire to the green luminaire wire

Connect the white wire to the white luminaire wire

Connect the black wire to the black luminaire wire

Connect the dimming wires if present – purple wire to purple wire and pink wire to pink wire. If dimming wires are not present, cap them with the smaller P2 wire connectors. Compatible with 0-10V dimmers.

8 CLOSE ARM COVER

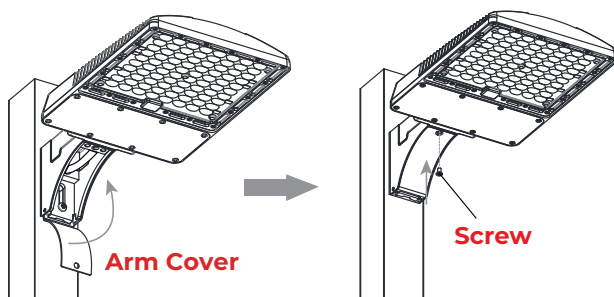

Carefully insert all wires inside the arm and secure the arm cover with the screw.

9 ACCESS TO SELECTION SWITCHES

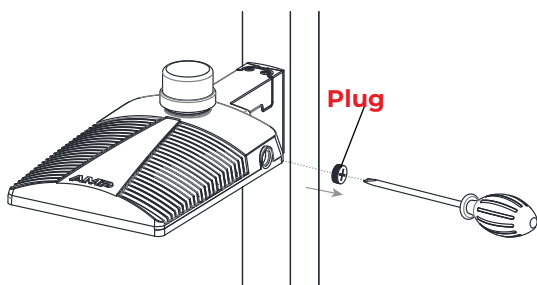

Using the screwdriver, unscrew the plug from the side of the luminaire.

10

COLOR TEMPERATURE (CCT) & POWER SELECT SWITCHES

**Color Temperature
Selection Switch**
5000K- 4000K- 3000K

**Power Selection
Switch**
40W, 60W, 80W, 90W

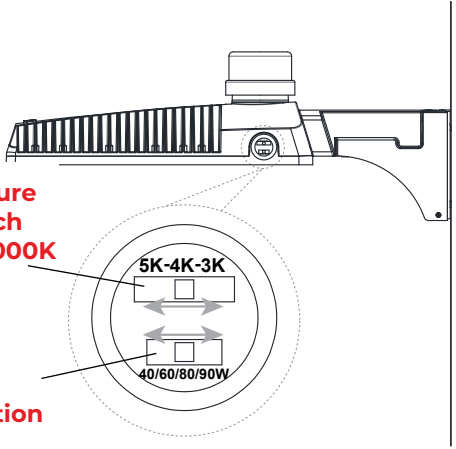

T

ACCESS TO SELECTION SWITCHES

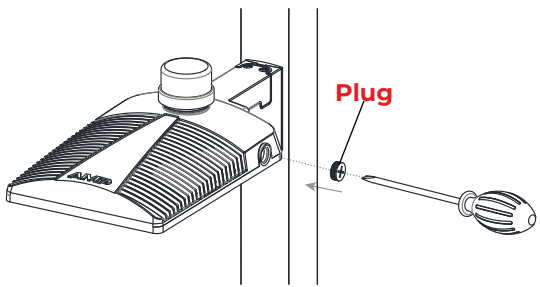

Using the screwdriver, thread previously removed waterproof screw back onto the side of the luminaire. Hand tighten until snug.

11 EPA RATINGS FOR POLE MOUNT

EPA Recommendations			
Luminaire	Mouting	Tilt	EPA
ASA-4301-90S-UNV-S-AM	Arm	0°	0.8

AMP® SECURE INSTALLATION & MAINTENANCE GUIDE

AMP® SECURE Area Light - ASA-4301-90S-UNV-S-AM

AMP® SECURE

1-813-978-3700 • Mon-Fri 9am-6pm (ET)

Specifications and product details subject to change without notice.

© Copyright 2024, AMP® Lighting, Lutz FL USA 33549 • All rights reserved.

customersupport@amplighting.com • amplighting.com