

INSTALLATION INSTRUCTIONS



VOLT® Grow

VOLT® Master Control System

VGAC-CN2

Help Hotline:

1-813-978-3700 • Mon-Fri 8am-8pm • Sat-Sun 10am - 6pm (EST)

Specifications and product details subject to change without notice.
© Copyright 2021, VOLT® Lighting, Lutz FL USA 33549 • All rights reserved.
customersupport@voltlighting.com • 813.978.3700



Advantages

This controller is used to replace the often cumbersome installation with contractors and timers. It adds safety features such as automatic dimming of your lights at high temperatures and even a safety shutdown.

The functions are:

1. Set output level from 0% to 115%.
2. Sunrise/Sunset timing setup.
3. Temperature and humidity sensors with solid cable connection.

Advantages of this product:

1. No need for a switchboard.
2. Easy and safe installation (low voltage device).
3. Protected against short circuit.
4. Double temperature safety feature.
5. Control up to 50 fixtures.
6. Show output as W or %.
7. Auto shutdown at temperature setting.

Connect Controller with Smart Phone

1 Install “Tuya Smart” APP

Method 1:
Scan the following
QR Code.



Method 2:
Download the APP from APP
Store or Android market.

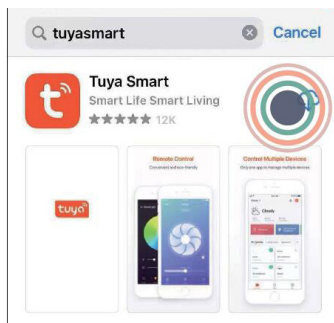

2 Sign Up and Log in “Tuya Smart”

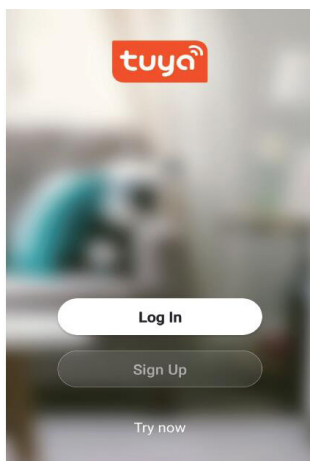

If you do not have an “Tuya Smart” account, “Sign Up” first. Once you have an account, “Log In” the APP with your account.

Turn on the Bluetooth on your smart phone.



3 Open “Pair” Dashboard on Controller

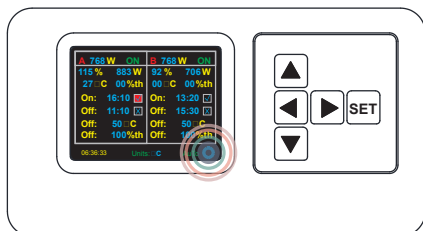

1) Click the blue wheel icon on the bottom right of the screen to display the menu.

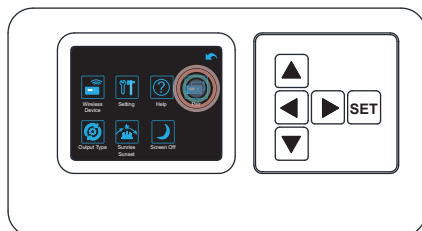

2) Click “Pair” to open the pair dashboard.

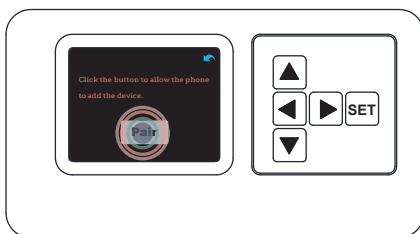

3) Click “Pair” and wait for pairing.

4 Add Controller to “Tuya Smart”

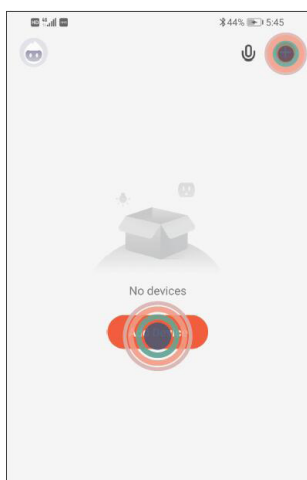

1. Click “+” button or “Add Device” button on the “Tuya Smart” APP.

4 Add Controller to “Tuya Smart” Continued

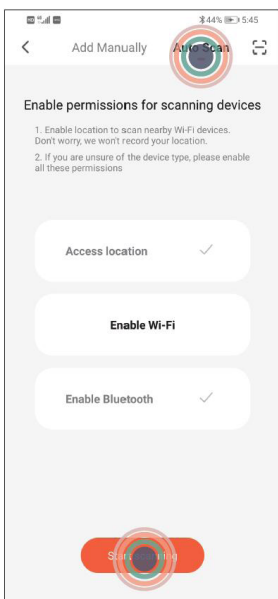

1. Make sure the Bluetooth has been turned ON. Choose “Auto Scan” and click “Start Scanning”.



2. If new device (controller) is found, click “Next”.

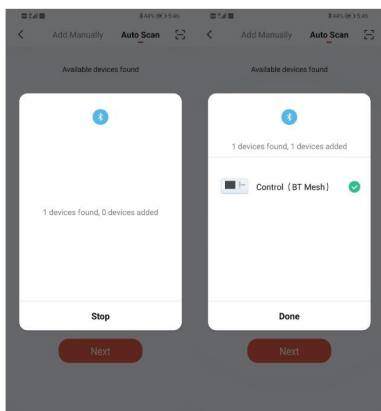

3. Wait for a moment until the new device (controller) has been connected. Click “Done” to complete the connection.



5 Control with Smart Phone

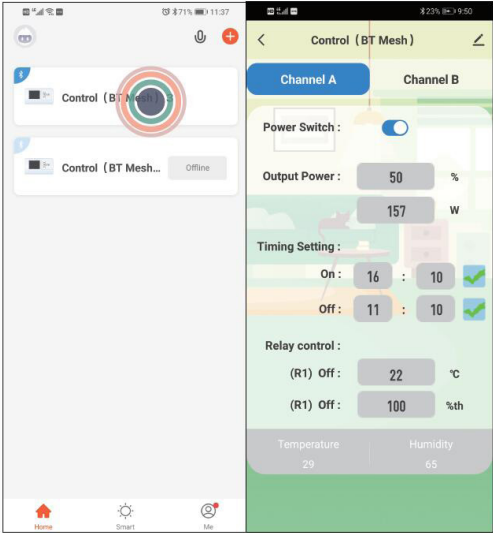

Find the added device (controller) on the “Tuya Smart” and open the dashboard. Configure the parameters to control your LED lights.

Connect Master Control System to Grow Light

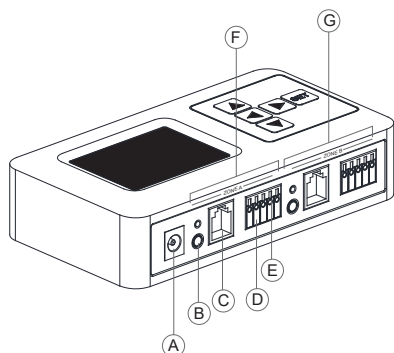

CONNECTIONS	
A	5V DC input
B	3.5mm Jack aux temperature sensor
C	RJ14 aux port for controlling up to 50 pcs fixtures
D	Relay switch controlled by temperature sensor
E	Relay switch controlled by humidity
F	Zone A
G	Zone B, same functions as Zone A

1 Connect Controller to Grow Light Fixture

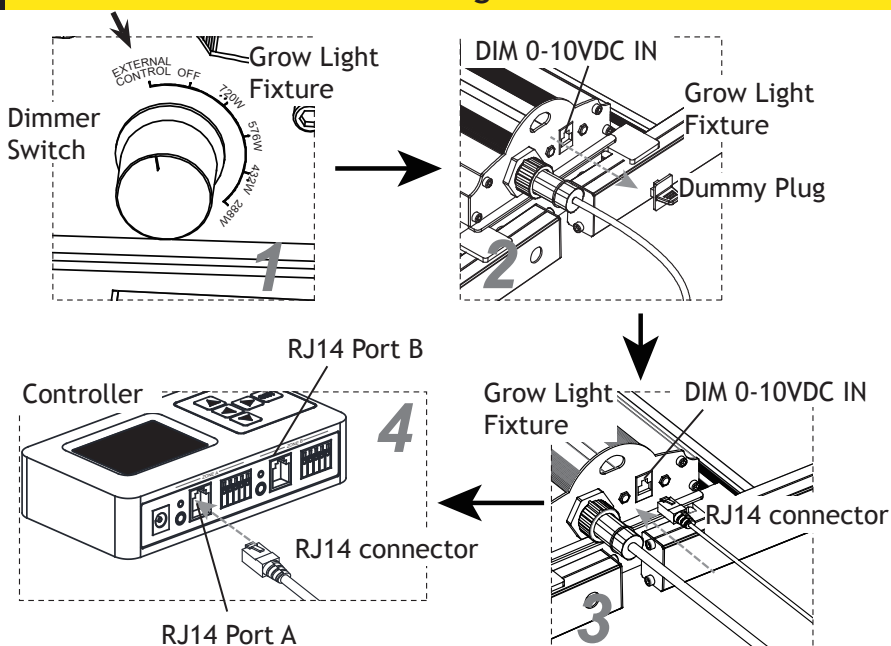

1. Rotate the dimmer switch on the grow light fixture to the "EXTERNAL CONTROL" location.
2. Remove the dummy plug from the "DIM 0-10VDC IN" port next to the power cord on the grow light fixture.
3. Insert the RJ14 connector on one end of the controller cable into the "DIM 0-10VDC IN" port on the grow light fixture.
4. Insert the RJ14 connector on another end of the controller cable into the "RJ14 Port A" on the controller.



2 Connect Grow Lights

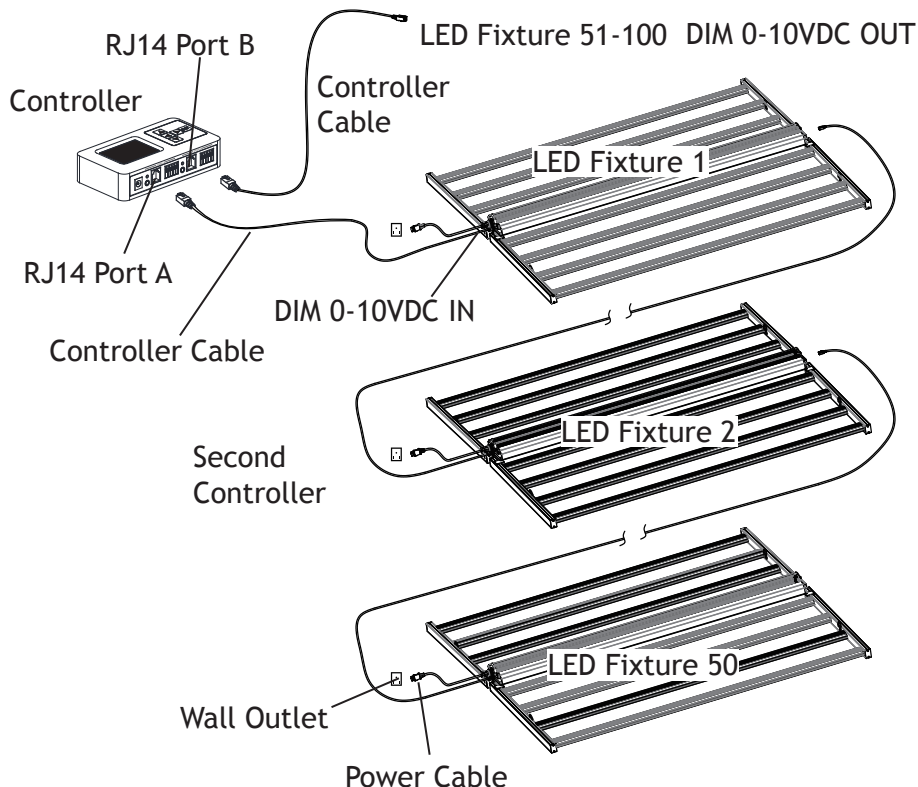

NOTE: To function correctly, the dimmer switch on each grow light fixture should be turned to the “EXTERNAL CONTROL” location.

- Refer to Step 1 to connect one controller cable to the controller device and the first grow light fixture.
- Remove the dummy plug on the “DIM 0-10VDC OUT” Port of the first grow light fixture. Connect the RJ14 connector of the second controller cable to this OUT Port.
- Remove the dummy plug from the “DIM 0-10VDC IN” Port on the second grow light fixture. Connect the second controller cable from the first grow light fixture to this IN Port.

2 Connect Grow Lights Continued

- Repeat the above steps to connect up to 50 grow light fixtures to port RJ14 Port A.
- Use the same processes of RJ14 Port A to connect up to 50 grow light fixtures to RJ14 Port B.

3 Connect Power Cord

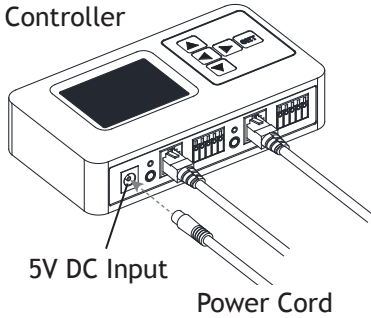

Insert the power cord into the 5V DC input on the controller.

Set Up Master Control System

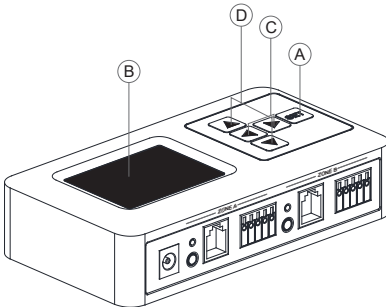

CONTROLLERS		
	Key	Function
A	Set	To get cursor (long press)/Confirm (short press)
B	Display	Display status and controller menu
C	Right/Left	Move cursor
D	Up/Down	Change the value



Using Master Control System

- 1) Click the blue wheel icon on the bottom right of the screen to display the menu.

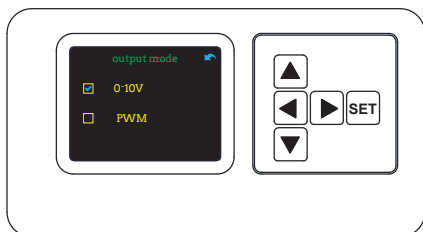
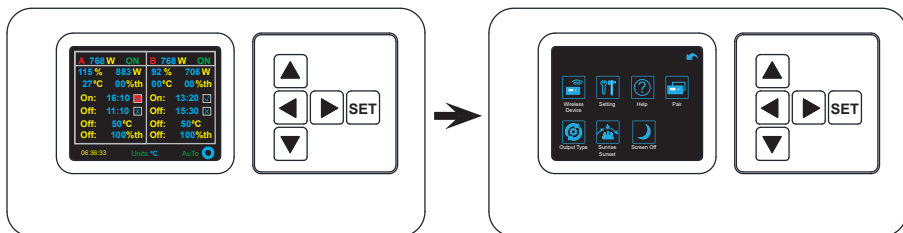

Select output type setting: 0~10V

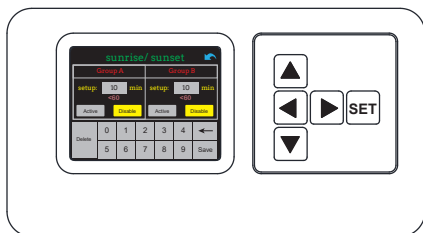

Sunrise/Sunset settings:

1. Group A corresponds to Zone A, Group B corresponds to Zone B.
2. Click the “Active” button to start the sunrise/sunset function of the group. Click the “Disable” button to stop the sunrise/sunset function of the group.
3. The gradient time can be set from 0 to 60 minutes.

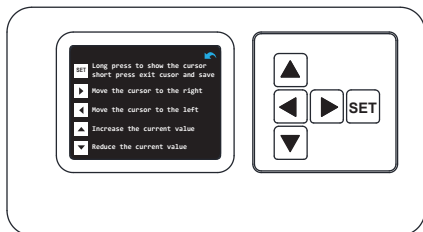

Help page.

Using Master Control System Continued

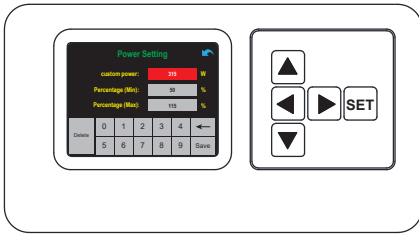

Custom Power:

Custom Power can be selected in the power settings on the main page.

Percentage (Min):

Set the minimum percentage of main page power.

Percentage (Max):

Set the maximum percentage of the main page power.

Set custom power to:
720W for FL-1
440W for VL-1

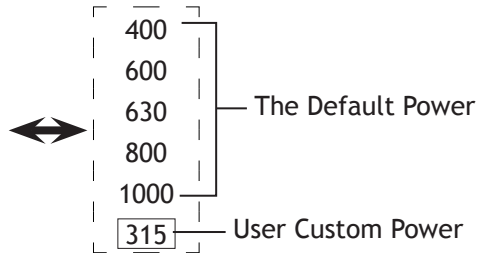
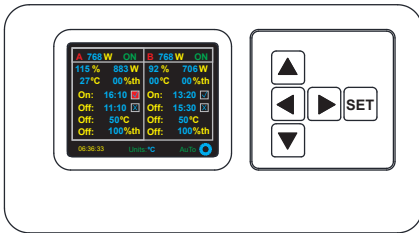

Return back to home page, it is set successfully.

Notes: Above is the power setting or order. User Custom Power comes last, users can choose the corresponding power according to the needs.

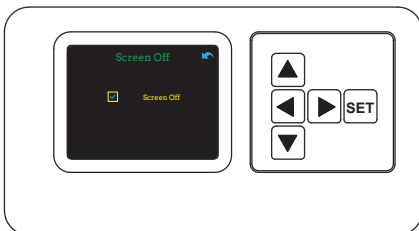

If there is no operation within 5 minutes, the controller will enter the screen saver mode.



Help Hotline:

1-813-978-3700 • Mon-Fri 8am-8pm • Sat-Sun 10am - 6pm (EST)

www.voltlighting.com

Specifications and product details subject to change without notice.
© Copyright 2021, VOLT® Lighting, Lutz FL USA 33549 • All rights reserved.
customersupport@voltlighting.com • 813.978.3700