

ring



Motion Sensor
Smart Lighting

1. Set up your Motion Sensor.

Download the Ring app.

The app walks you through setting up and managing your Motion Sensor.

Search for “Ring” in one of these app stores, or visit: ring.com/app



Set up your Ring Bridge.

The Bridge connects your Ring Smart Lights to the Ring app and the rest of your Ring devices.

To set up your Bridge, follow the instructions in the Ring app or the Bridge user manual.



Remove the front cover.

Pull the tabs on the sides outward until you can remove the front of your Motion Sensor.

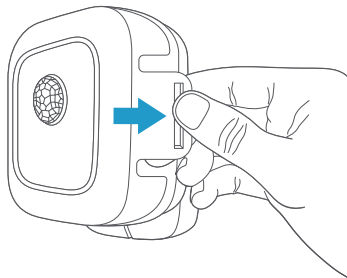

Insert the batteries.

Insert three AAA batteries (not included), matching the flat ends with the springs.

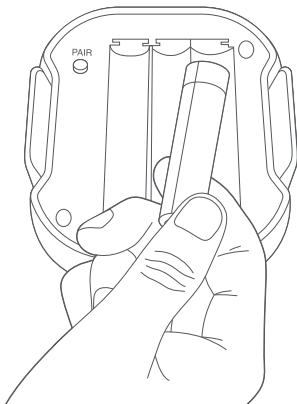

Set up your Motion Sensor in the Ring app.

In the app, tap **Set Up a Device**.

When prompted, select **Smart Lights** and follow the in-app instructions.

Once setup is complete, you can replace the front of your Motion Sensor.



2. Install your Motion Sensor.

Remove the base.

Slide the base down to remove it from your Motion Sensor.

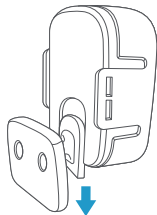

If installing on a masonry surface, use the base as a template to mark pilot holes. Drill the holes and insert the anchors.

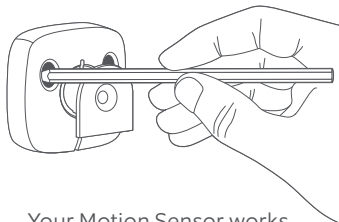

i Your Motion Sensor works best when mounted 4-6 feet above the ground.

Drive the screws.

Hold the base firmly against the surface and drive the two mounting screws.

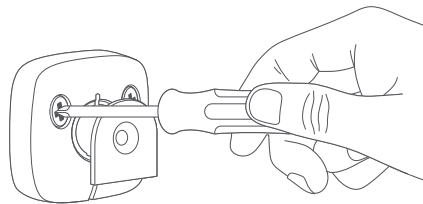

Attach the Motion Sensor.

Then slide your Motion Sensor back onto its base until it clicks into place.

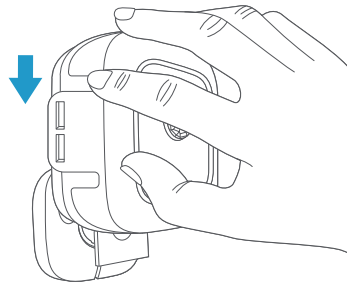

For additional help, visit: ring.com/help

Or give us a call...

[US 1 800 656 1918](tel:18006561918)

[Canada 1 855 300 7289](tel:18553007289)

[Worldwide +1 310 929 7085](tel:+13109297085)

For a list of all our customer support numbers, visit: ring.com/callus

To review your warranty coverage, please visit www.ring.com/warranty.

Patents: www.ring.com/patents

© 2019 Ring LLC or its affiliates.

RING, ALWAYS HOME, and all related logos are trademarks of Ring LLC or its affiliates.

Last updated: 01/04/19