

INSTALLATION INSTRUCTIONS

VOLT® OHM 8" DVC Subwoofer

ITEM: VAU-SBW-6-PBZ

1-813-978-3700 • Mon-Fri 8am-8pm • Sat-Sun 10am - 6pm (ET)

! WARNING

The installation of this system requires digging or trenching. It is recommended to contact a local contractor to ensure there is no damage done to the power, gas or water lines. It could result in property damage, personal injury or death. National phone number for the US is 811.

PACKAGE CONTENTS

- | | |
|----------------------|---|
| A. (1) DVC Subwoofer | C. (3) Leveling Feet |
| B. (1) Ground Stake | D. (1) 12' 16 AWG Plug and Play Extension Cable |

PARTS REQUIRED (SOLD SEPARATELY)

- A. Shovel or Trench Tool
B. Smartphone or Tablet

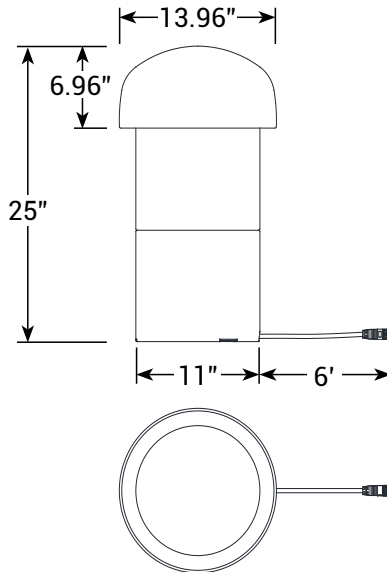
PRODUCT DIMENSIONS

1 LAY THE 12FT PLUG AND PLAY CABLE

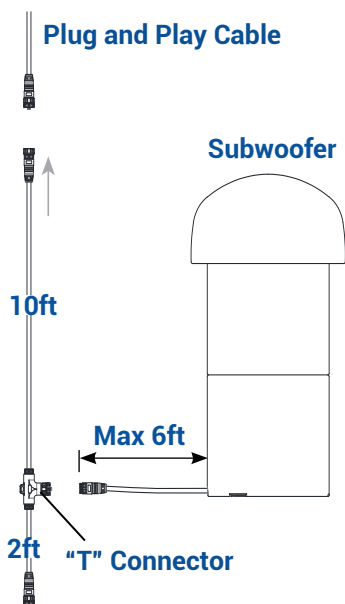

1. The DVC subwoofer comes prewired with a 6ft of cable. The distance from the subwoofer to the "T" connector on the plug and play cable is maximum 6ft.

The DVC subwoofer can be connected anywhere in the run. It connects both left & right channels together. It acts like two bass speakers in one. A subwoofer typically will allow more bass if it's up against a wall or a solid surface but can be placed anywhere.

Four installation methods are available for the subwoofer. Choose one of the installation methods below before continuing the rest of the installation.

1. Stake: Install the subwoofer to ground directly.
2. Leveling feet: Place the subwoofer onto the ground or deck.
3. Bracket: Install the subwoofer to hard surface.
4. Place the subwoofer directly onto the landscape.

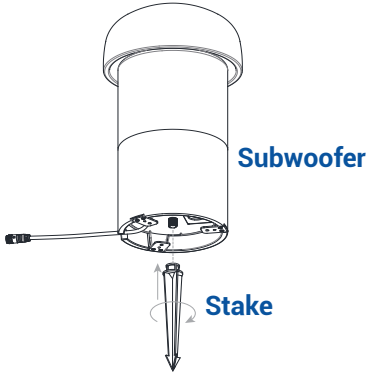
INSTALLATION METHOD 1: STAKE**2 INSTALL STAKE TO SUBWOOFER**

Thread the stake to the bottom of the subwoofer.

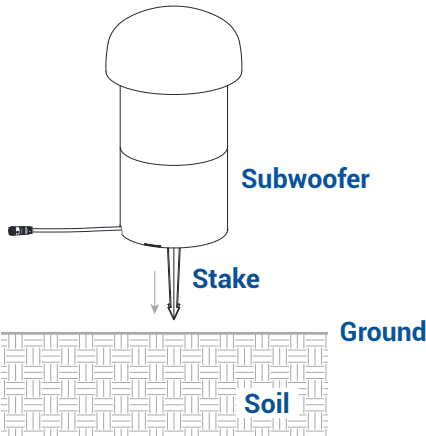
3 INSTALL STAKE TO GROUND

Insert the stake into the ground until the bottom of the subwoofer flush to the ground.

Go to the Complete Installation Section.

INSTALLATION METHOD 2: LEVELING FEET

2 INSTALL LEVELING FEET

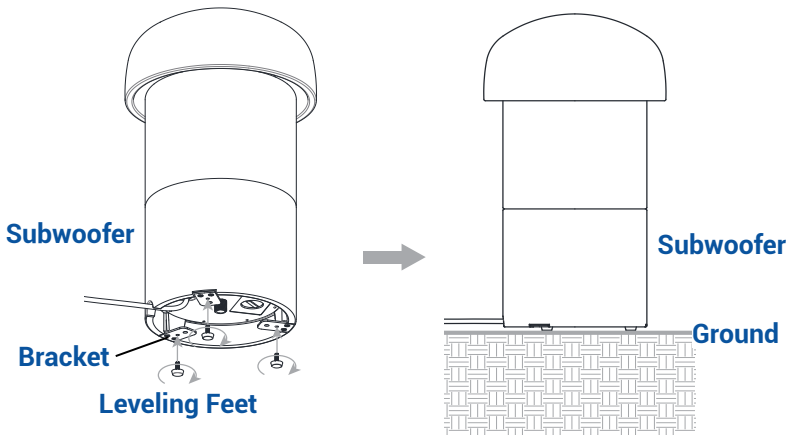

Thread the leveling feet onto the bottom bracket of the subwoofer.

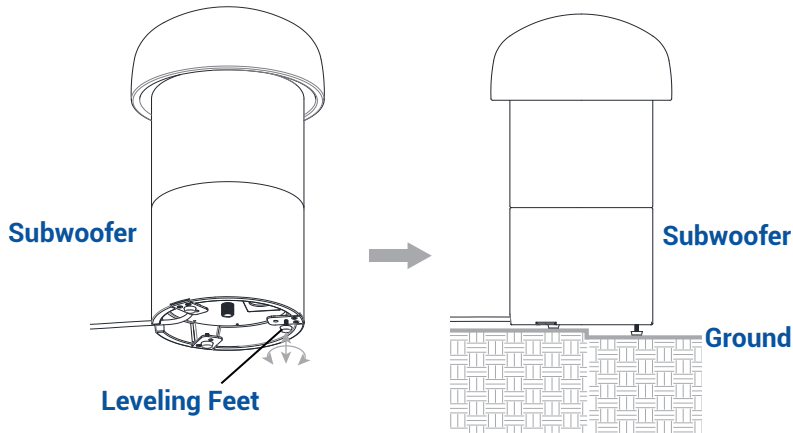

Adjust the feet as needed to ensure the subwoofer is level. For the best stability, place the subwoofer on a flat surface.

Go to the Complete Installation Section.

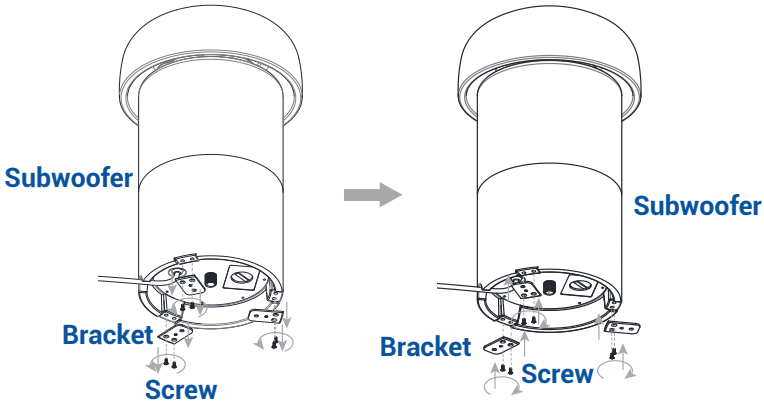
INSTALLATION METHOD 3: BRACKET**2 REVERSE BRACKET**

Loosen the screws to remove the brackets from the bottom of the subwoofer. Reverse the brackets and install them back to the bottom of the subwoofer. Secure with previously removed screws.

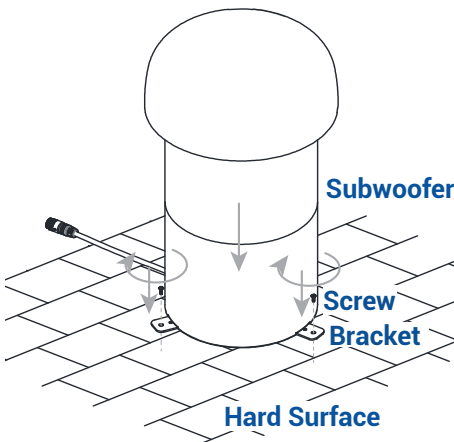
3 INSTALL SUBWOOFER TO HARD SURFACE

Place the subwoofer on a hard surface. Pass the screws through holes on the bracket and drill them into the hard surface to secure the subwoofer.

Go to the Complete Installation Section.

INSTALLATION METHOD 4: DIRECTLY ONTO LANDSCAPE

2 DIG HOLE

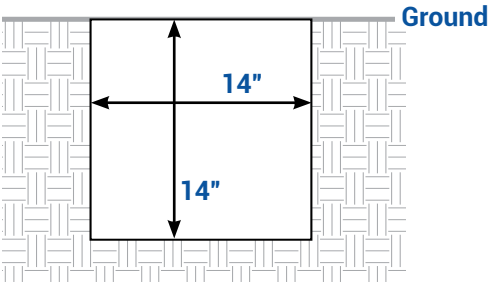

Dig a 14" x 14" hole in the desired area.

3 FILL GRAVEL

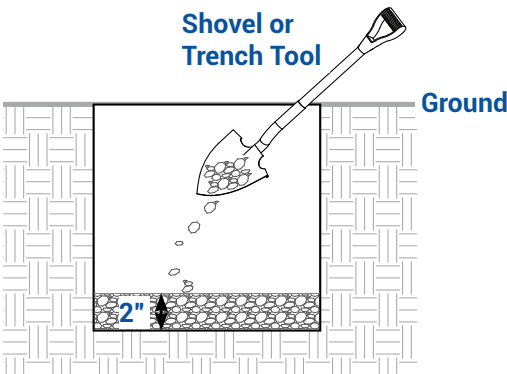

Fill with 2" of gravel.

4 PLACE SUBWOOFER INSIDE THE HOLE

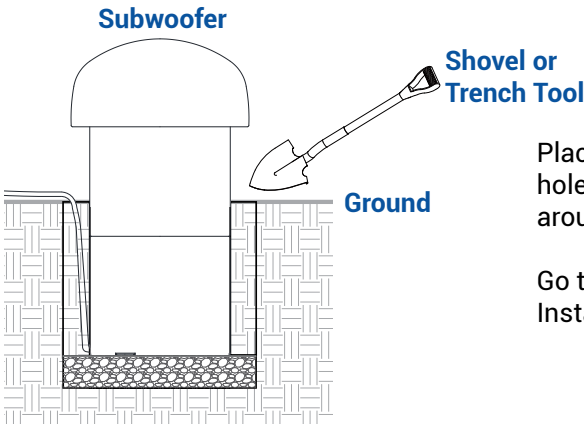

Place the subwoofer in the hole and fill in the areas around the subwoofer.

Go to the Complete Installation Section.

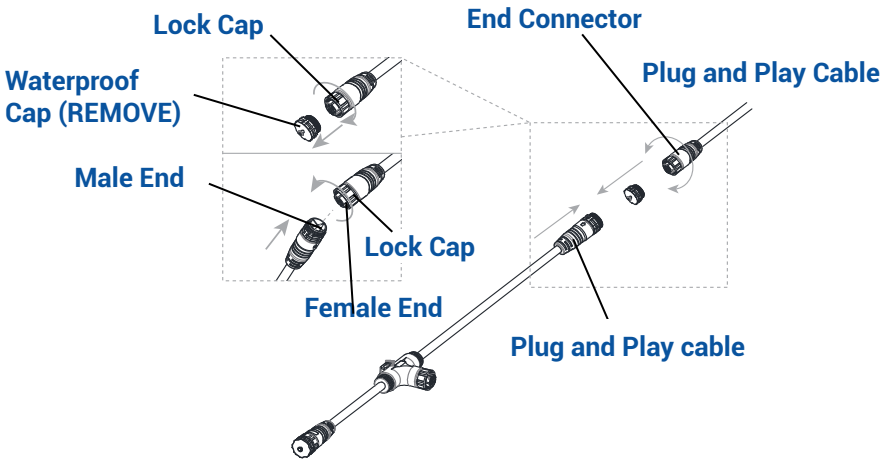
COMPLETE INSTALLATION**CONNECT 6FT PLUG AND PLAY CABLE**

Connect the subwoofer and the desired plug and play cable together.