



## AMP® Low Voltage Landscape Lighting AMP® NovelPro Path Light (Lamp Ready)

### Product Description

The AMP® NovelPro Path Light is a professional grade fixture with an elegant and ornate appearance. It complements most architectural and landscape styles. It provides wide, evenly dispersed illumination, ideal for walkways and landscaped areas. The offset shade configuration allows for the stem to be set back while the illumination projects forward from the stem. This is good for situations where you need to insert the stake into the ground several inches beyond the edge of a pathway or garden. The AMP® NovelPro Path Light is covered by a lifetime warranty.

### Product Dimensions

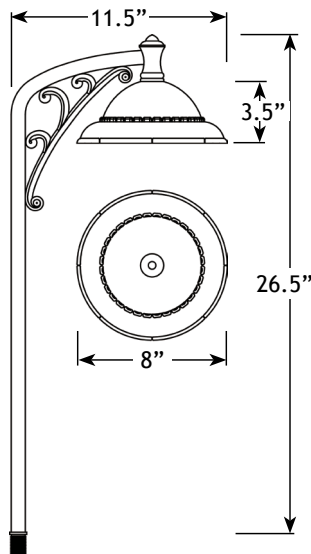

### Features & Benefits

- ▶ The offset shade configuration allows for light to be projected forward for a much larger lit area.
- ▶ Silicone plug at lead wire exit prevents ground moisture and insects from entering luminaire through the stem.
- ▶ Polycarbonate shatter-resistant lens.



### Specifications

- ▶ **Construction:** Brass
- ▶ **Finish:** Bronze
- ▶ **Lead Wire:** 18AWG
- ▶ **Mounting (included):** 10" Hammer Stake with cutout for wire exit
- ▶ **Lens:** Polycarbonate dome lens
- ▶ **Light Source (sold separately):** Bi-Pin (LED or Halogen)
- ▶ **Operating Voltage:** 12VAC
- ▶ **Powered by:** VOLT's Low Voltage Transformer

### Warranty

Lifetime Warranty

### Certifications

